



Seiko 7T62A,7T92A,7T94A Movement Parts (1)

Compiled by EmmyWatch - <https://www.emmywatch.com>

PARTS CATALOGUE/TECHNICAL GUIDE

Cal. 7T62A/7T92A/7T94A

[SPECIFICATIONS]

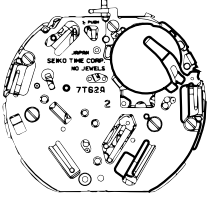
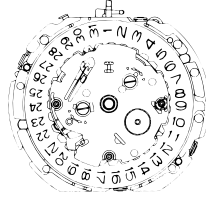
Cal. No.		7T62A	7T92A	7T94A
Item				
Movement				
		The illustrations refer to Cal. 7T62A.		(x 1.0)
Movement size	Outside diameter	Ø 27.6 mm		
	Casing diameter	Ø 27.0 mm		
	Height	3.3 mm		
Time indication	Main time	Hour, minute and small second hands		
	Stopwatch	Minute hand 1/5-second hand (moves at 0.2-second intervals)	Hour and minute hands Second hand 1/20-second hand (moves at 0.05-second intervals)	Minute hand 1/5-second hand (moves at 0.2-second intervals)
	Alarm	Hour and minute hands (Minute hand moves at 1-minute intervals.)		
Driving system		Step motor (Load compensated driving pulse type)		
		4 pcs.	4 pcs.	3 pcs.
Additional mechanism		<ul style="list-style-type: none"> • Electronic circuit reset switch • Train wheel setting device • Date calendar • Instant setting device for date calendar • Battery life indicator 		
		<ul style="list-style-type: none"> • Stopwatch function • Measures up to 60 minutes in 1/5-second increments. • Accumulated elapsed time measurement • Split time measurement 	<ul style="list-style-type: none"> • Stopwatch function • Measures up to 12 hours in 1/20-second increments. • Accumulated elapsed time measurement • Split time measurement 	<ul style="list-style-type: none"> • Stopwatch function • Measures up to 60 minutes in 1/5-second increments. • Accumulated elapsed time measurement • Split time measurement
		• Single-time alarm function		
Loss/gain		Monthly rate at normal temperature range: less than 15 seconds		
Regulation system		Nil		
Measuring gate by quartz tester		Use 10-second gate.		
Battery	Battery No.	SEIKO SR927W, SONY SR927W, Maxell SR927W, Matsushita SR927W	SEIKO SR927SW, SONY SR927SW, Maxell SR927SW, Matsushita SR927SW	
	Voltage	1.55 V		
	Battery life	Approx. 3 years	Approx. 3 years	Approx. 5 years
Jewels		Nil		

SEIKO WATCH CORPORATION

REMARKS ON REPAIRING CAL. 7T62A/7T92A/7T94A

Unlike the other Cal. 7T Series watches, which have two crowns and three buttons, Cal. 7T62A, Cal. 7T92A and Cal. 7T94A have one crown and two buttons. But their basic movement structure is similar in other respects, and the knowledge and technique you have gained in handling the previous Cal. 7T Series watches will come in handy when you repair Cal. 7T62A, 7T92A as well as 7T94A.

When repairing, however, you are requested to have the full knowledge of the features characteristic of these watches and strictly observe the repairing and checking instructions provided in this guide so that the watches will be repaired correctly.

FEATURES

As Cal. 7T62A/7T92A/7T94A has fewer crowns and buttons, the operating procedures for alarm setting (for Cal. 7T62A only), time setting and stopwatch hand position adjustment differ from those of the other Cal. 7T Series watches.

As a result of this structure change, the battery life of Cal. 7T62A/7T92A/7T94A has increased as compared with that of the other Cal. 7T series watches.



1. STOPWATCH FUNCTION

● Measurement performance

Cal. 7T62A and 7T94A: Measures up to 60 minutes in 1/5 second increments.

Displays the elapsed time with the stopwatch minute and 1/5-second hands.

Cal. 7T92A: Measures up to 12 hours in 1/20 second increments.

Displays the elapsed time with the stopwatch hour, minute, second and 1/5-second hands.

● Button operation

Standard Measurement



Accumulated Elapsed Time Measurement

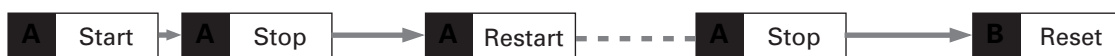

Split Time Measurement



Measurement of Two Competitors

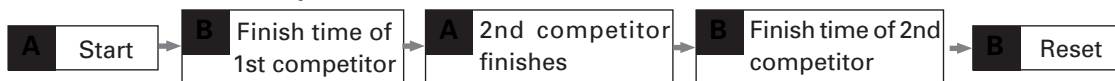

2. ALARM FUNCTION (For Cal. 7T62A only)

- The alarm sounds only once at a designated time within the coming 12 hours and it is automatically disengaged.
- Pushing the crown back into the normal position after setting the alarm will prevent the set alarm time from changing by an accidental pressing of the button. **A**

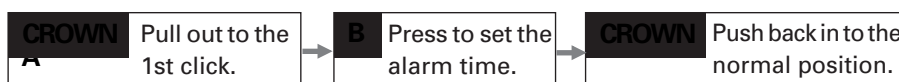

Disassembling procedures Figs. : ① → ⑤⑤

Reassembling procedures Figs. : ⑤⑤ → ①

Lubricating: Types of oil

- AO-3 (or MS-A)
- ▨ AO-2 (or MS-F)
- SEIKO Watch Oil S-6

Oil quantity

- Normal quantity
- Liberal quantity

The illustration refers to Cal. 7T62A, 7T92A and 7T94A.

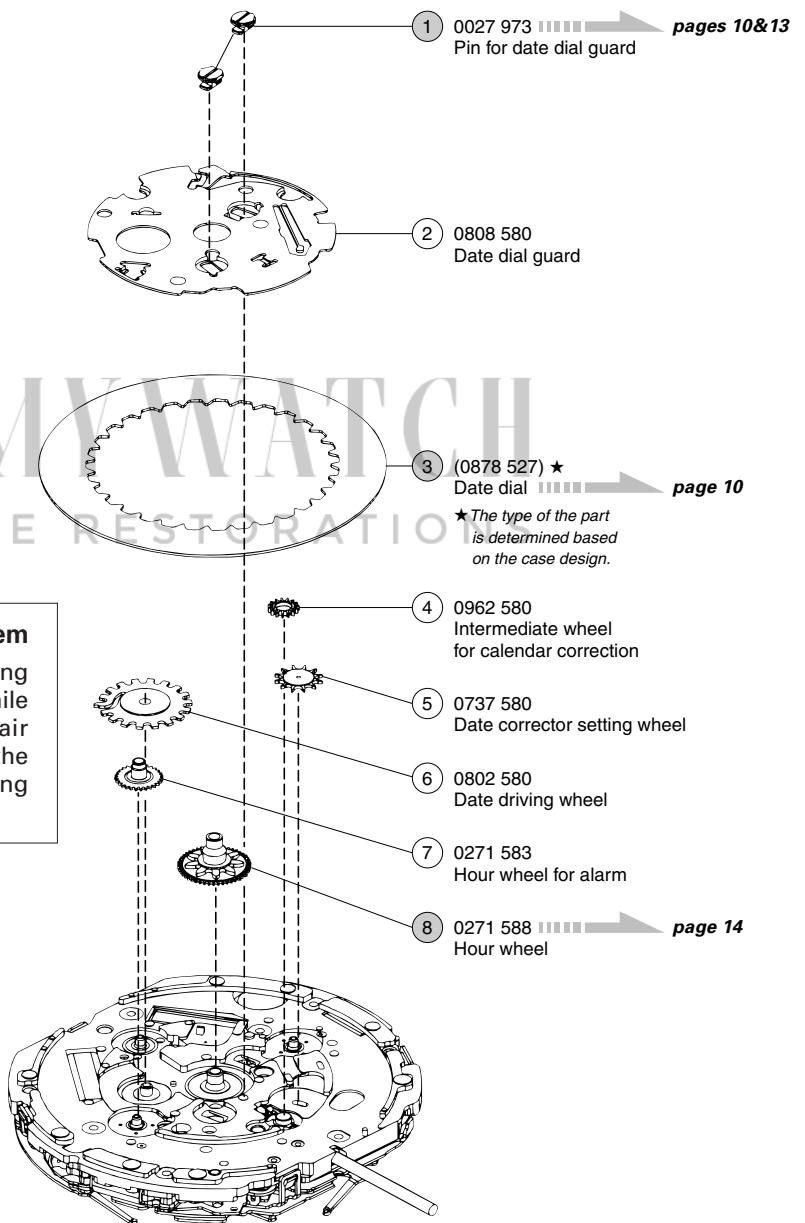

Remarks on removing the winding stem

To remove the winding stem when taking out the movement from the case or while disassembling the parts during repair work, be sure to pull out the crown to the first click, and then, remove the winding stem while pushing the setting lever.

○ ⇨ Please see the remarks on the following pages.
 Lubricating of some parts is shown in "II. REMARKS ON DISASSEMBLING AND REASSEMBLING."

PARTS CATALOGUE

Cal. 7T62A/7T92A/7T94A

The illustration refers only to Cal. 7T62A.

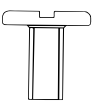
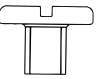
	0022 230 • Battery clamp screw (2 pcs.)
	0022 459 • Circuit block cover screw (4 pcs.)

(4589 801)
Piezoelectric element

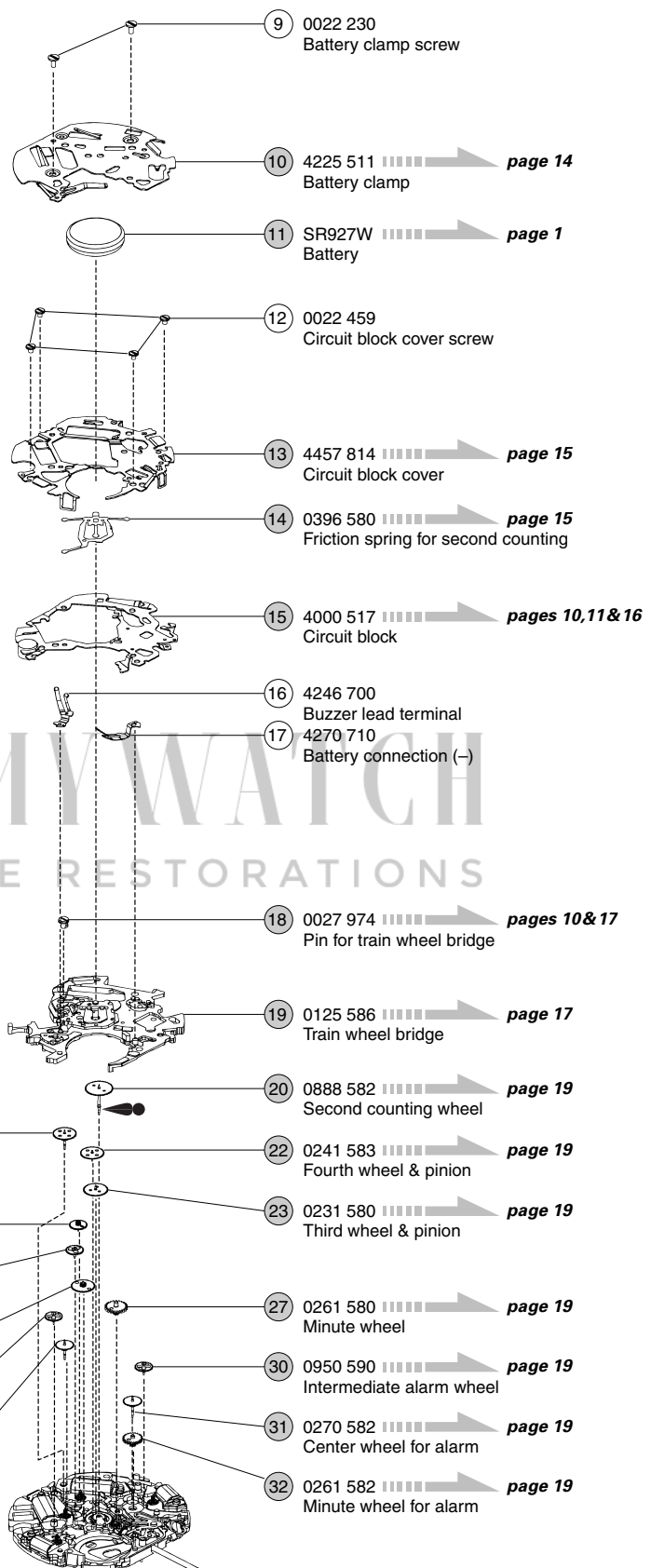
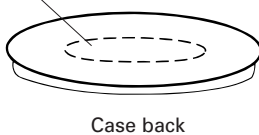

 Please see the remarks on the following pages.

Lubricating of some parts is shown in "II. REMARKS ON DISASSEMBLING AND REASSEMBLING."

The illustration refers only to Cal. 7T62A.

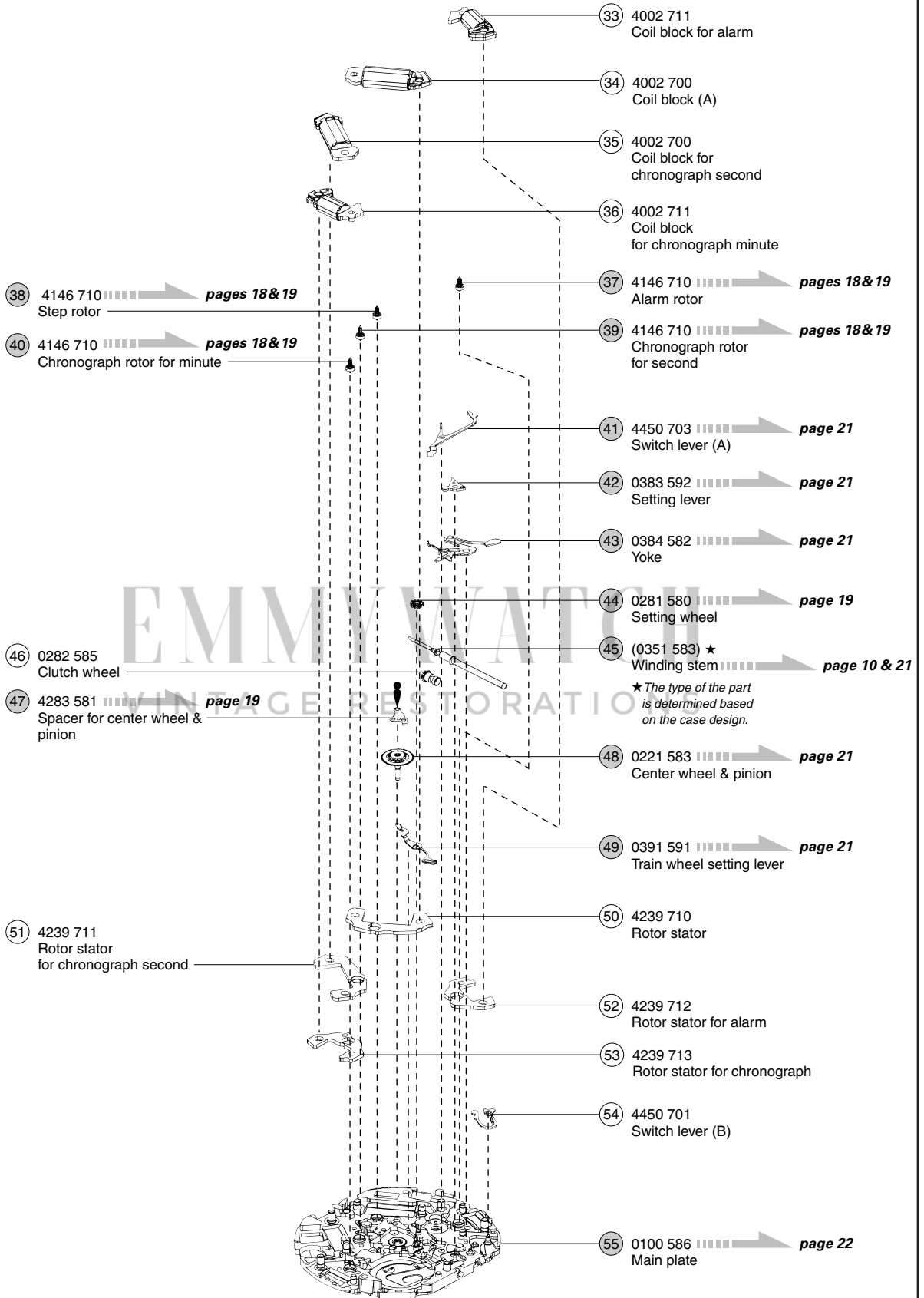

☉ ⇨ Please see the remarks on the following pages.

Lubricating of some parts is shown in "II. REMARKS ON DISASSEMBLING AND REASSEMBLING."

PARTS CATALOGUE

Cal. 7T62A/7T92A/7T94A

The illustration refers only to Cal. 7T92A.

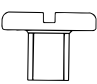
	0022 230 • Battery clamp screw (2 pcs.)
	0022 459 • Circuit block cover screw (4 pcs.)

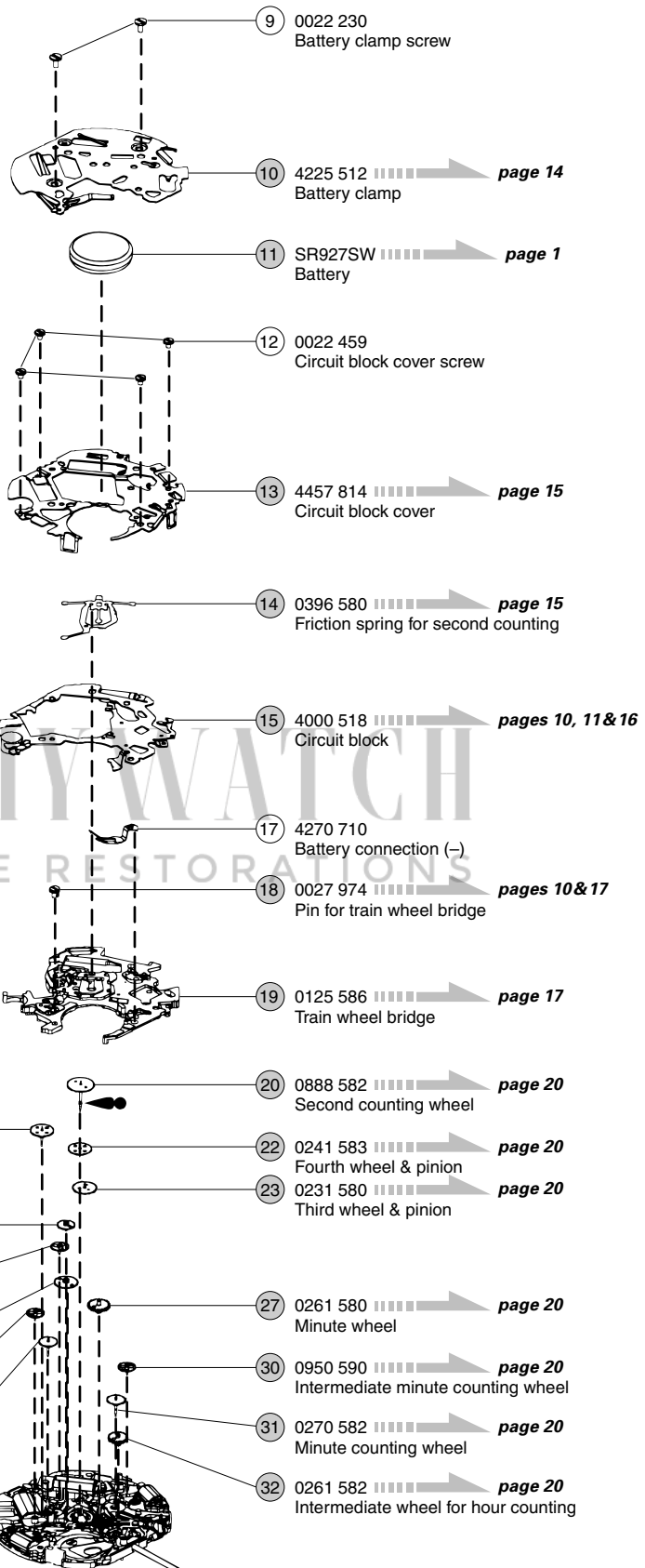

☉ ➡ Please see the remarks on the following pages.

Lubricating of some parts is shown in "II. REMARKS ON DISASSEMBLING AND REASSEMBLING."