

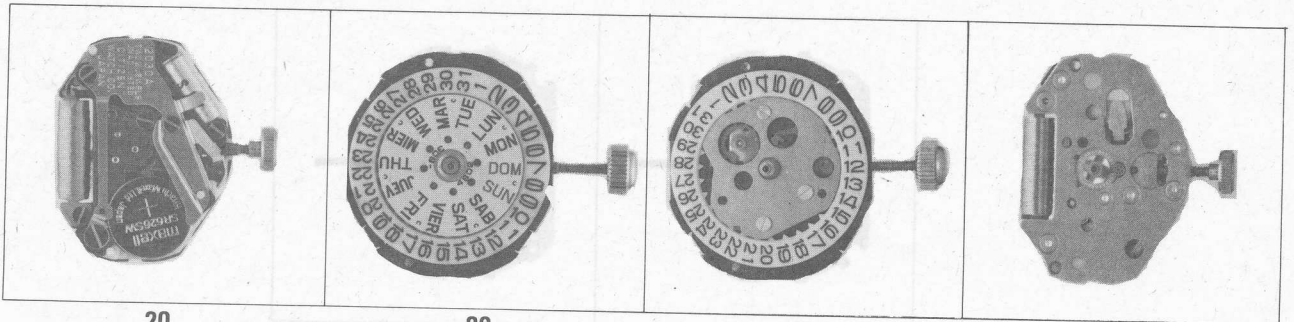

Citizen 2000,2110,2180 Movement Parts (1)

Compiled by EmmyWatch - <https://www.emmywatch.com>

Catalog No. 20¹-1 ~ 20²-2



20¹-1
(Catalog No.)

20²-2
(Catalog No.)

20²-2
(Catalog No.)

20²-2
(Catalog No.)

2100A

- Analog quartz watch (center second)
- Date/day mechanism
- Date/day quick setting mechanism
- Power saving switch
- Second hand stopping device

Thickness: 3.8mm

2000A · 2001A · 2002A

- Analog quartz watch (center second)
- Date/day mechanism
- Date/day quick setting mechanism
- Power saving switch
- Second hand stopping device

Thickness: 3.8mm

2020A

- Analog quartz watch (with no center second)
- Power saving switch

Thickness: 2.8mm

2110A

- Analog quartz watch (center second)
- Date mechanism
- Date quick setting mechanism
- Power saving switch
- Second hand stopping device

Thickness: 3.8mm

2010A

- Analog quartz watch (center second)
- Date mechanism
- Date quick setting mechanism
- Power saving switch
- Second hand stopping device

Thickness: 3.8mm

2030A · 2031A

- Analog quartz watch (center second)
- Power saving switch
- Second hand stopping device

Thickness: 2.8mm

Size: 22.6 x 22.0 x 23.7φmm

Size: 16.3 x 17.8 x 18.1φmm

2040A · 2041A

- Analog quartz watch (with small second)
- Power saving switch
- Second hand stopping device

Thickness: 3.6mm

2140A

- Analog quartz watch (center second)
- Dual time
- Power saving switch
- Second hand stopping device

Thickness: 3.8mm

Size: 15.3 x 17.8 x 18.1φmm

Size: 22.6 x 18.0 x 23.7φmm

Oscillation per second	32,768Hz
------------------------	----------

Catalog No. 20
21-1

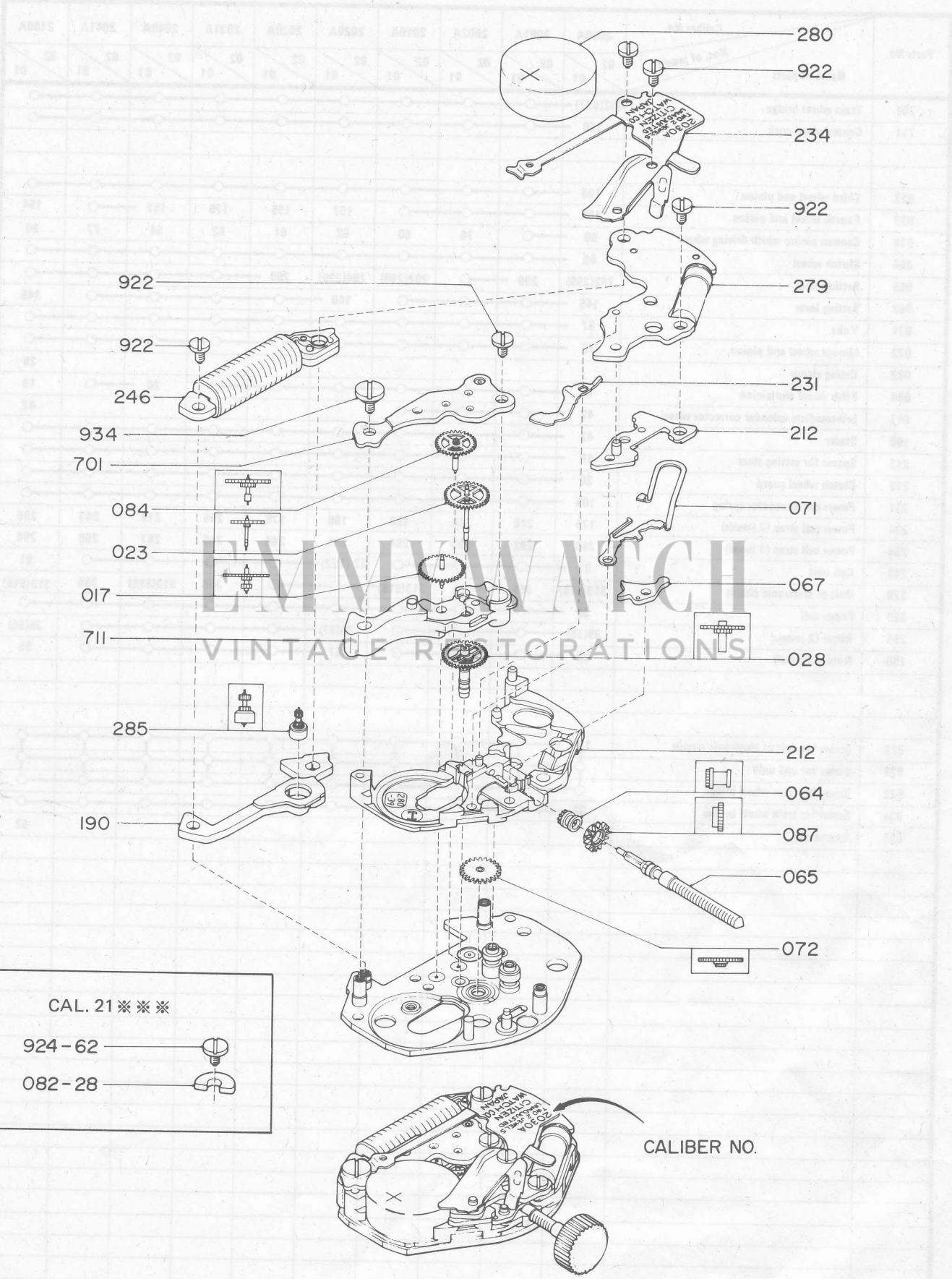

Parts No.	Name of parts	Caliber No.		2000A		2001A		2002A		2010A		2020A		2030A		2031A		2040A		2041A		2100A			
		Nos. of jewels		02		02		02		02		02		02		02		02		02		02		02	
		01	01	01	01	01	01	01	01	01	01	01	01	01	01	01	01	01	01	01	01	01	01	01	
701	Train wheel bridge	492(537)																							
711	Center wheel cock	100																							
017	Third wheel and pinion	103																							
023	Fourth wheel and pinion	154									157	155	176	157									154		
028	Cannon pinion whith driving wheel	60			76	60				62	61	82	64	77										60	
064	Clutch wheel	66																							
065	Setting stem	292(299)	299			292(299)	294(299)	299																	
067	Setting lever	145						146																145	
071	Yoke	67																							
072	Minute wheel and pinion	76																							
082	Casing clamp																							28	
084	Fifth wheel and pinion	19																20						19	
087	Intermediate calendar corrector wheel	42																						42	
190	Stater	42																							
212	Spacer for setting stem	19																							
212	Clutch wheel guard	20																							
231	Power cell connector spring	105																							
234	Power cell strap (2 jewels)	175	215	242	189	186	176	255	218	243	198														
234	Power cell strap (1 jewel)	283	292	293	284	285	286	295	287	296	288														
246	Coil unit	91				92 (122)																		91	
279	Unit of electronic circuit	313(518)	356		313(518)			356	313(518)	356	313(518)													313(518)	
280	Power cell	39																							
285	Rotor (2 jewels)	35(55)					36(57)																	35(55)	
285	Rotor (1 jewel)	55					57																	55	
922	Screw for unit of electronic circuit	154																							
922	Screw for coil unit																								
922	Screw for train wheel bridge																								
934	Screw for train wheel bridge	32																							
924	Case screw																							62	

CAL. 204***A**

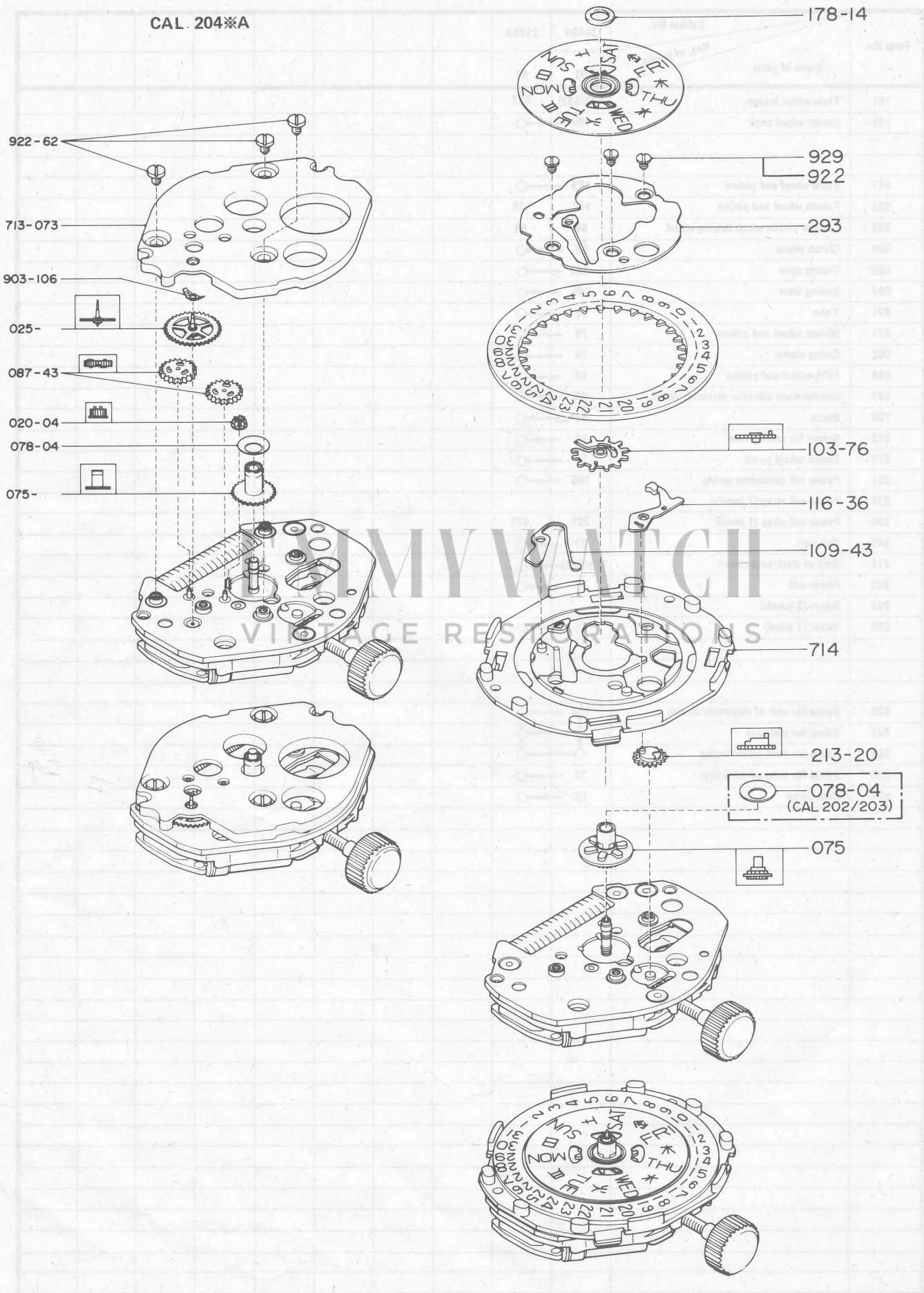

CAL. 2180A

CAL. 2180A

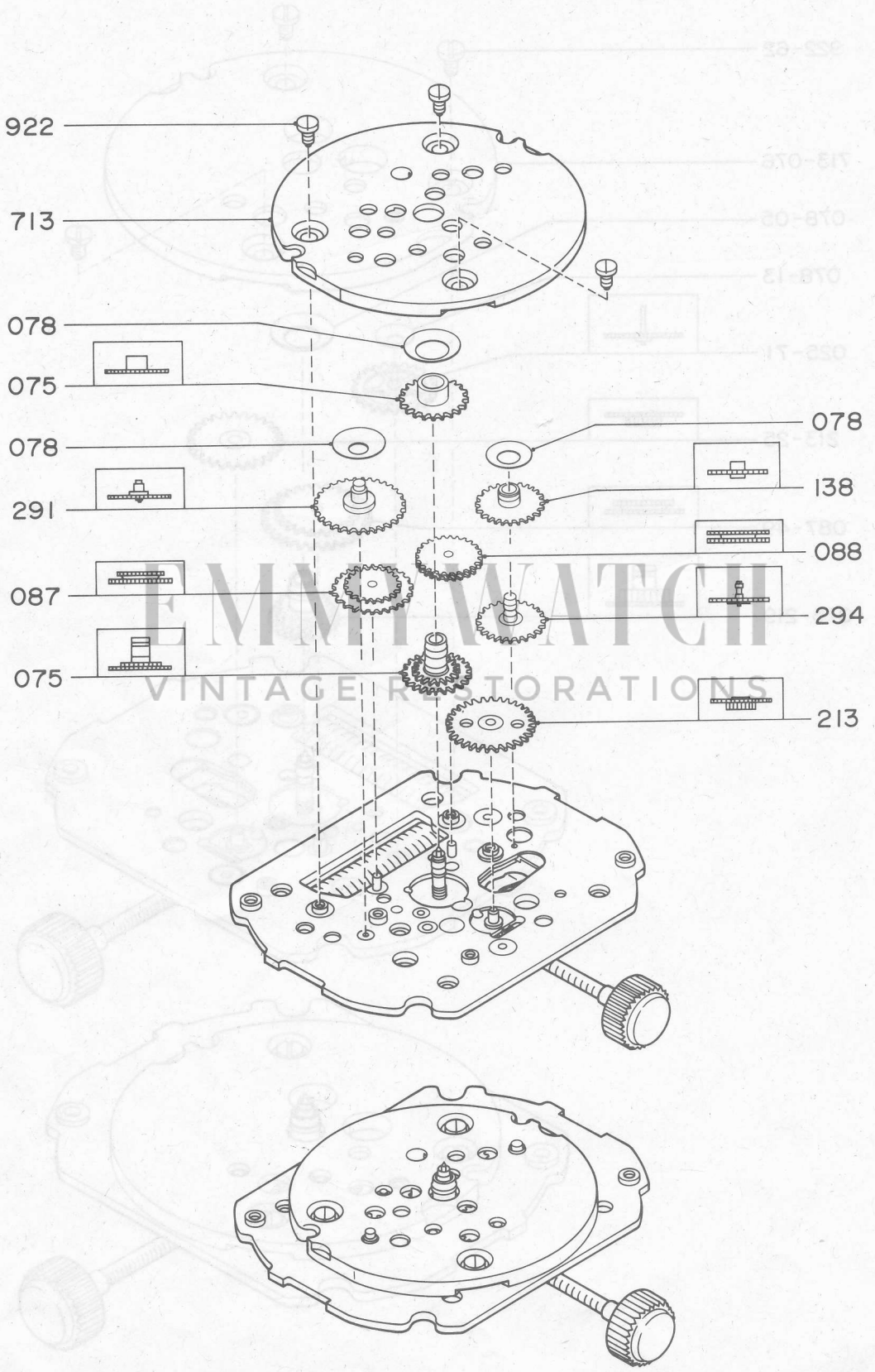

Catalog No. 20-21

Parts No.	Name of parts	Caliber No.																				
		2000A		2001A		2002A		2010A		2020A		2030A		2031A		2040A		2041A		2100A		
		02	01	02	01	02	01	02	01	02	01	02	01	02	01	02	01	02	01	02	01	
713	Dial guard																073	○				
714	Calendar plate	028	○	○	○	○																029
020	Lower fifth pinion																04	○				
025	Second wheel																68	70				
075	Hour wheel	192	○		207	192			193	○		217			196	208	192					
078	Dial washer								04	○	○	○	○	○	○	○						
087	Intermediate second wheel														43	○						
103	Date dial driving wheel	76	○	○	○	○																76
109	Date jumper	43	○	○	○	○																43
116	Date corrector lever	36	○	○	○	○																36
178	Day dial gib	14	○		09																	14
213	Date corrector wheel	20	○	○	○	○																20
293	Date dial guard	34	○	○			35															34
903	Friction spring for second wheel																106	○				
929	Screw for date dial guard	39	○	○																		39
922	Screw for date dial guard						147															
922	Screw for dial guard																62	○				

EMMYWATCH
VINTAGE RESTORATIONS

Jewels

Parts No.	Name of parts	Caliber No.																				
		2000A		2001A		2002A		2010A		2020A		2030A		2031A		2040A		2041A		2100A		
		02	01	02	01	02	01	02	01	02	01	02	01	02	01	02	01	02	01	02	01	
942	Rotor/U	81	○	○	○	○	○	○	○	○	○	○	○	○	○	○	○	○	○	○	○	○
942	Rotor/L																					
950	Second wheel/U																67	○				
950	Second wheel/L																164	○				

Parts No.	Name of parts	Caliber No.		2110A	2140A	2180A							
		Nos. of jewels											
		02	01	01	01								
713	Dial guard				076	080							
714	Calendar plate	029											
025	Dial time wheel				71								
075	Hour wheel	192		219									
075	Double-coothing hour wheel					246							
075	Hour wheel (II)					248							
078	Dial washer				18	22							
078	Dial washer (II)				13								
078	Sun wheel washer					04							
078	Shadow wheel washer					○							
087	Intermediate dual time wheel				49								
087	Intermediate sun wheel					73(57)							
088	Reduction wheel					16							
103	Date dial driving wheel			76									
109	Date jumper			43									
116	Date corrector lever			36									
138	Shadow wheel					21							
178	Day dial gib			14									
213	Date corrector wheel			20	25	28							
291	Sun wheel					04							
293	Date dial guard			35									
294	Moon wheel					06							
922	Screw for dial guard				62	○							
922	Screw for date dial guard			147									

EMMY WATCH
VINTAGE RESTORATIONS

[Jewels]

Parts No.	Name of parts	Caliber No.		2110A	2140A	2180A							
		Nos. of jewels											
		02	01	01	01	01							
942	Rotor/U			81	○	○							
942	Rotor/L			○	○								
950	Rotor/L					171							
950	Sun W/L					184							