



EMMYWATCH
VINTAGE RESTORATIONS

Certina 17-351 Movement Parts (1)

Compiled by EmmyWatch - <https://www.emmywatch.com>

CERTINA

7 $\frac{3}{4}$ '''

Ancre - 27 rubis
 Seconde au centre directe
 Automatique
 Quantième à guichet
 Ah (Alternances horaires) 21600

Cal. 17-351



7 $\frac{3}{4}$ '''

Pallet-fork - 27 jewels
 Direct sweep second
 Automatic
 Date showing through aperture in dial
 Ah (Alternations per hour) 21600



7 $\frac{3}{4}$ '''

Ancora - 27 rubies
 Segundero central directo
 Automático
 Calendario con ventanilla
 Ah (Alternaciones horarias) 21600

7 $\frac{3}{4}$ '''

Anker - 27 Rubine
 Direkte Zentrumsekunde
 Automatisch
 Datum mit Fenster
 Ah (Halbschwingungen pro Stunde) 21600

EMMYWATCH
 VINTAGE RESTORATIONS

7 $\frac{3}{4}$ '''

Ancora - 27 rubini
 Secondo al centro diretto
 Automatico
 Calendario a finestra
 Ah (Alternazioni orarie) 21600

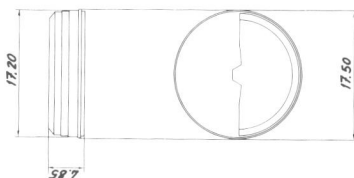

1:1



17-351

100



17-351

105



17-351

110



17-351

114



17-351

121



17-351

125

CERTINA

1:1

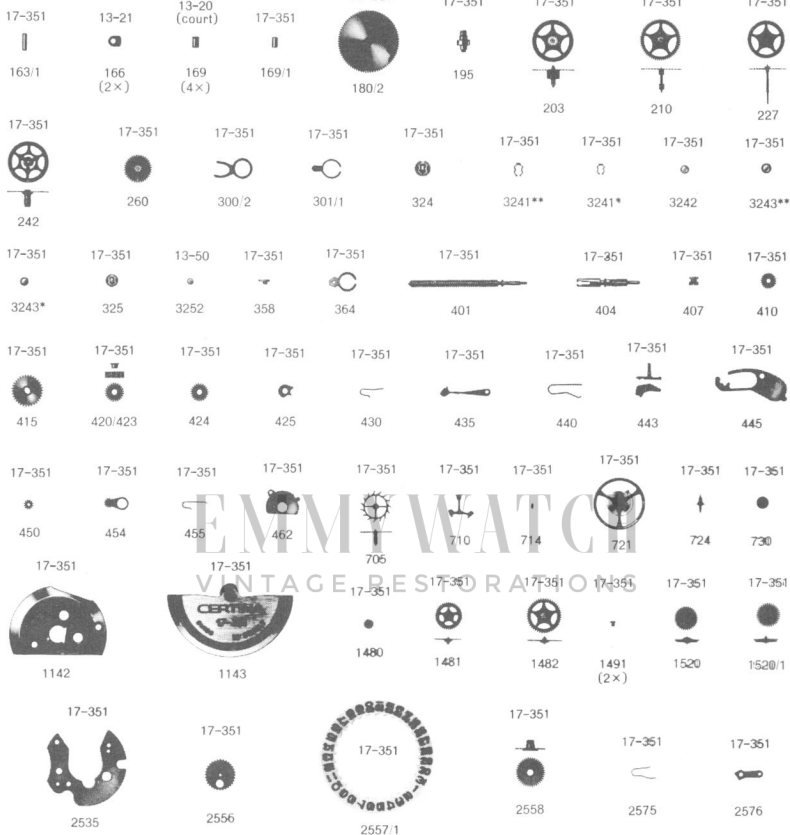

2:1

